

# DIGITAL WIRELESS BACKUP CAMERA SYSTEMS

User Manual / Installation Instructions



Before Operating The Set Please Read The Instructions Completely.

## System Features

1. Instant Real-time Video Transmission.
2. This is ideal for cars, trucks, SUVs, Pickups or any vehicle where you want to add a backup camera
3. There are no wires from the backup camera to the monitor, they are separate installation, so it is very easy to install, you do not have to run the wires from the back to the front.
4. The monitor can be fixed on dash or windshield optional.
5. Monitor viewing is HD color and with guide lines built-in camera.
6. Backup camera design with AUTO-Lighting LED lights make your night driving much safer.
7. Digital signal transmission is totally different from analog signal transmission. The signal is point to point. There is no interference from other devices.

## What You Get

### > What's in the Box

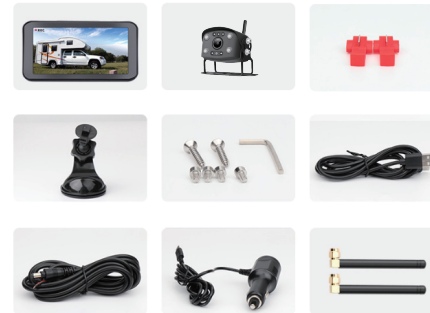

Wireless Backup Camera/Monitor  
Cigarette lighter adapter/Magnetic bracket  
Standing Bracket/Power cable with transmitter  
3M glue/User Manual

**NOTE:** The contents included may be different based on the kit you purchased. Please take the actual product as standard.

## Wiring Guide

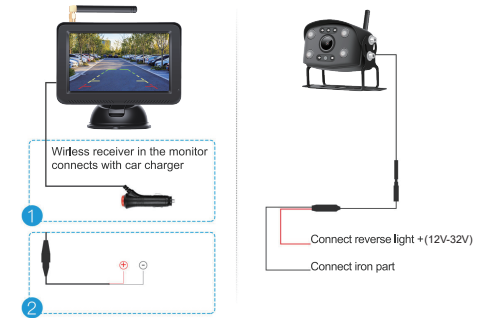

### TIPS:

1. The camera is powered by the reversing light, please find out the reversing light with the test pencil, then connect the red wire of the camera to it and the black to the iron part.
2. The monitor is directly connected to the cigarette lighter to get the power. You can turn the display on or off with the red button on the cigarette lighter.

## Getting Started

### > Monitor key function



- ① Power
- ② ① Confirm key ② After inserting the card, start/pause recording
- ③ ① Into the menu from the left to ② - ③ car ruler shortcut button ④ adjust the MWH mode of the ruler position
- ④ Menu key return key
- ⑤ ① Select ② \* ③ from the right of the menu and press the switch channel ④ After the ruler is opened, long press M, then press V, then press H.

**NOTE:** TF Card running speed greater than Class 10, Max support 128G

## Pairing the Camera and Monitor



1. Select the channel to be pairing
2. Enter the menu and select pairing



3. Start pairing
4. Waiting for matching and drawing successfully

**NOTE:** when you need pairing, please confirm the circuit is properly connected and powered. If you need to pairing multiple cameras, please switch to the corresponding channel.

## 5 Inch Wireless Monitor Specification

LCD Size:	5 Inch Color Monitor
TF Card:	Max support 128G
Operating Frequency:	2400-2483.5MHZ
Transmitted Power:	23db
Resolution:	800(H) x480(V)
Brightness:	500 cd/m <sup>2</sup>
Response Time:	25ms
TV System:	PAL/NTSC
Contrast:	500:1
Power Supply:	DC 12V-32V

## Wireless Backup Camera Specification

Waterproof Rating:	IP68
Image Sensor:	1/3" HD (2MP)
Operating Frequency:	2400-2483.5MHZ
TV System:	NTSC/PAL
Resolution:	1920x1080(2MP)
Minimum Illumination:	0,001 Lux
Transmitted Power:	23db
View Angle:	110°[H]138°[V]
Power Supply:	DC 12V-32V
Operating temperature:	-20 C ~ +70 C
Storage temperature:	-30 C ~ +80 C

## Trouble Shooting

If you have problem when operating this product, please refer to this section. The most common problems are list below, along with likely cause and solution.

### Signal Problem :

Check if Get Power Correctly for Both the Camera and Monitor , If Yes, Then Check if Get Signal When Working Distance With 2M.

### Missing Part:

Not Brand New Without Installation Guide : We Ask Warehouse Guy Checked Again for All Our Stock To Make Sure All set Brand New With All Parts and User Manual

Stop Working No Power: May Be Connection Loose , Just Check the Connections Again , and Make Sure All Voltage is Correctly and Make Sure You are In Reversing Gear to Test it if You Get Power From Reversing Lights