

- DE** Montageanleitung
- EN** Assembly Instructions
- NL** Montagehandleiding
- SV** Monteringsanvisning

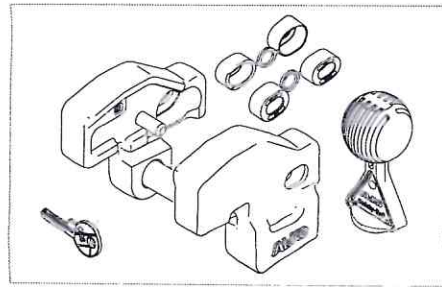

AL-KO Safety AK 181 / AK 270

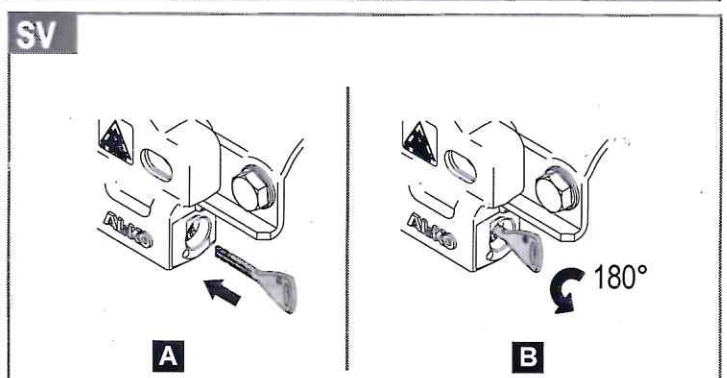
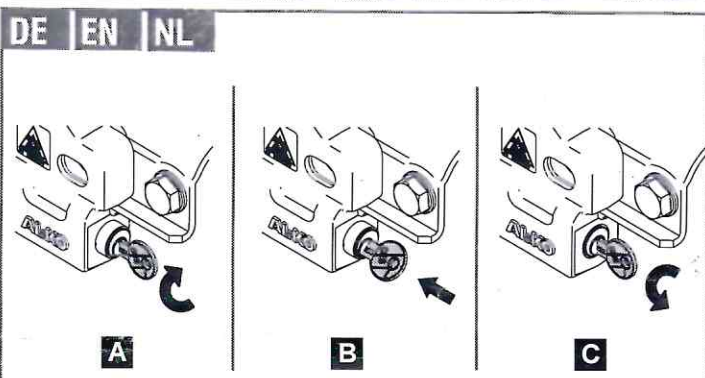
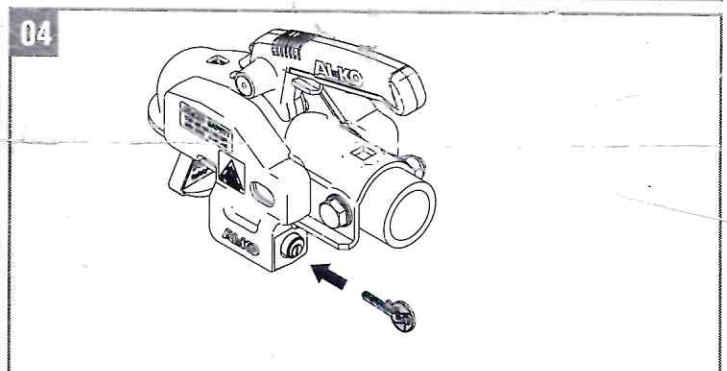
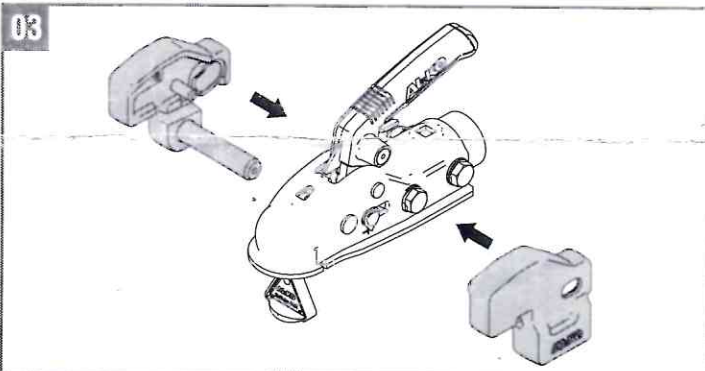
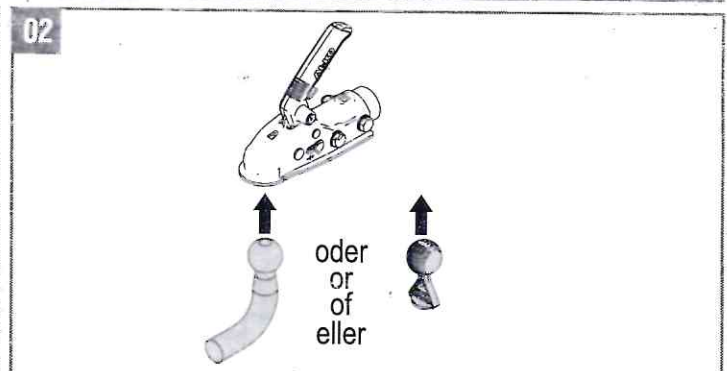
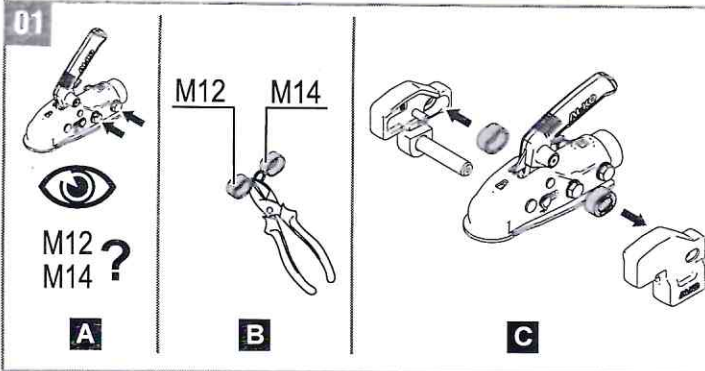

- DE**
- EN**
- NL**
- SV**

Erforderliche Angaben für den Ersatzschlüssel / Required information for the spare key /
Informatie vereist voor reservesleutel / Nödvändig information för reservnyckeln :

- a) ETI - No. _____
- b) SMC-Label-No. (NL): P3 _____
- c) Key - Number : _____
- d) Name / Address : _____